



Corinthian Cast Stone

# Anchors & Shims

## Ordering Catalog

 **CORINTHIAN**  
**CAST STONE, INC.**

*Delivering Quality without Compromise*





## HIGH-IMPACT PLASTIC HORSESHOE SHIMS

Corinthian Cast Stone high-impact horseshoe shims allow fast, easy, low-cost leveling of precast stones, limestones, masonry applications and storefronts. Eliminate the guesswork, our shims are color-coded according to thickness. We offer 10 sizes and 3 thicknesses.

### FEATURES:

- Maximum service life – high-impact polymer is inert
- Low cost, non-staining, color-coded, perfectly balanced
- Light weight, easy to use, easy to install
- Unaffected by liquids, natural chemical and alkalis
- Will not rust or leach when exposed to moisture
- ASTM rating of 5000 psi compressive strength
- Classified – slow burning, no toxic fumes
- Automatic insulation between dissimilar metals
- Available in 10 stock sizes and 3 thicknesses
- **Custom sizes and rectangular stock available**

**BLACK**

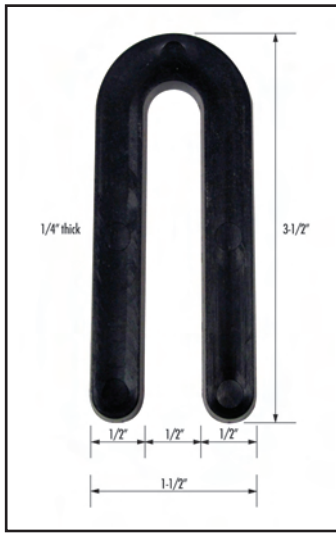

2004-007-0012

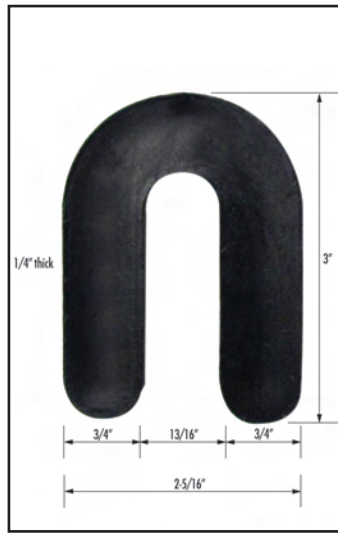

2004-007-0009

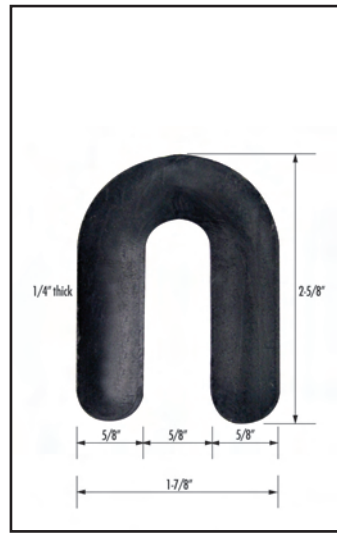

2004-007-0006



2004-007-0003

**RED**

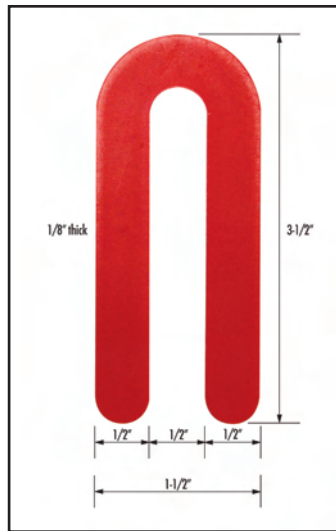

2004-007-0011

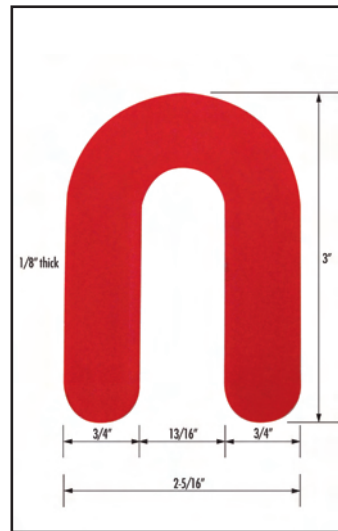

2004-007-0008

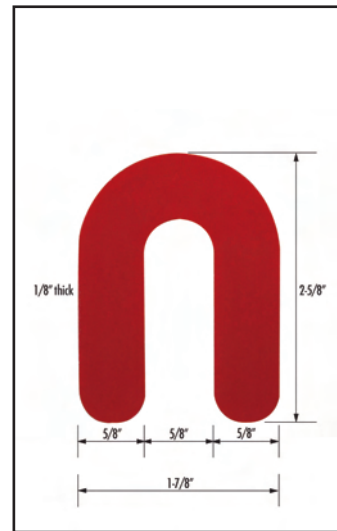

2004-007-0005

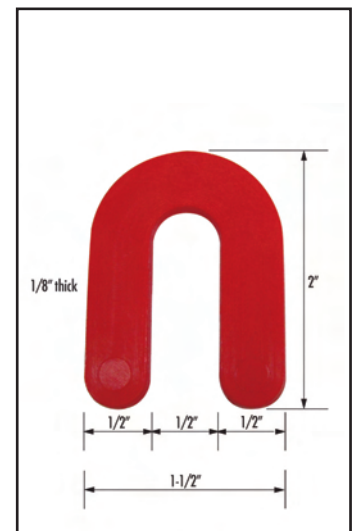

2004-007-0002

**BLUE**

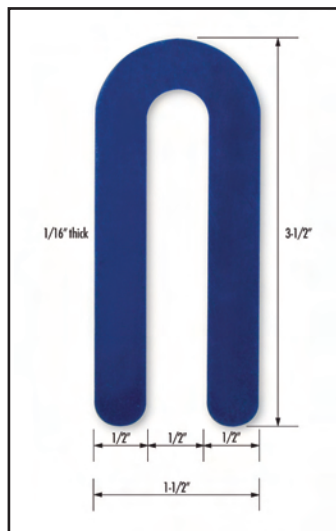

2004-007-0010

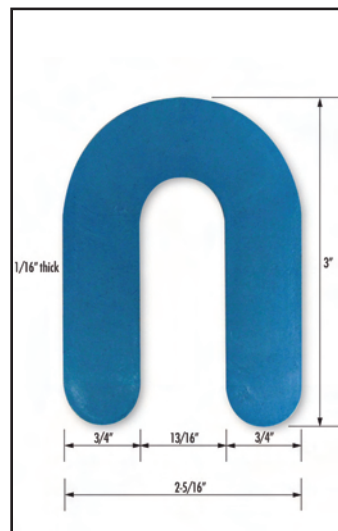

2004-007-0007

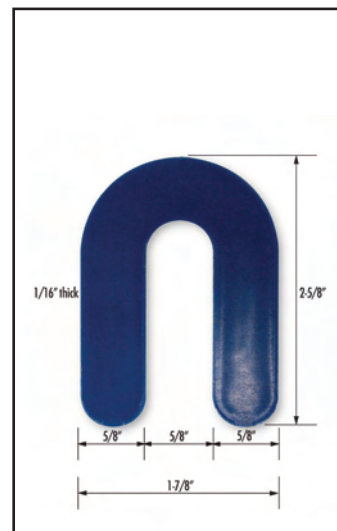

2004-007-0004

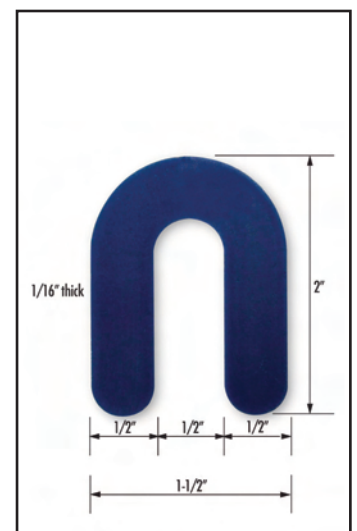

2004-007-0001

# STONE ANCHOR EXPRESS™

Our production facility is equipped to weld, shear, punch and bend any metal from brass, bronze, aluminum, carbon or stainless steel. Shims, fasteners, epoxy as well as sealers, cleaning supplies and custom colored mortar are available.

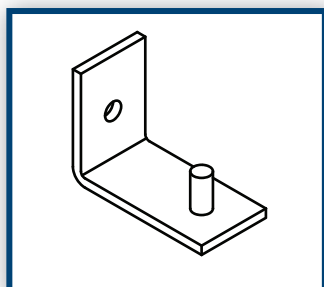

**STA-01:**  
"L" ANCHOR WITH WELDED PIN

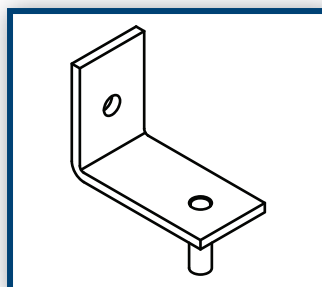

**STA-02:**  
"L" ANCHOR WITH WELDED PIN

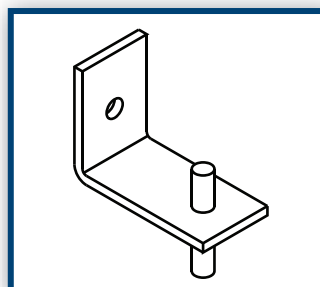

**STA-03:**  
"L" ANCHOR WITH PIN

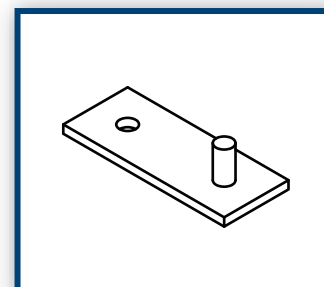

**STA-04:**  
FLATSTOCK WITH WELDED PIN

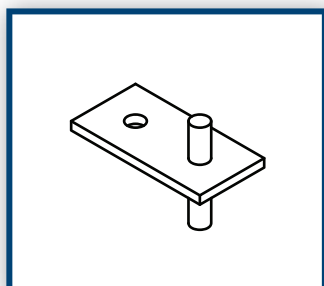

**STA-05:**  
FLATSTOCK WITH PIN

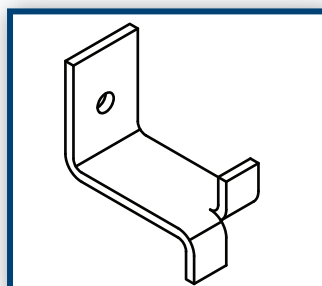

**STA-06:**  
SPLIT TAIL

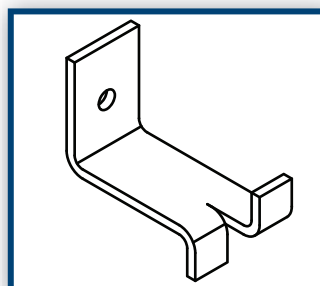

**STA-07:**  
SPLIT TAIL

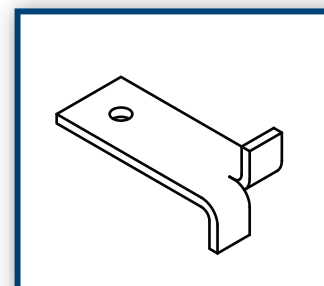

**STA-08:**  
SPLIT TAIL

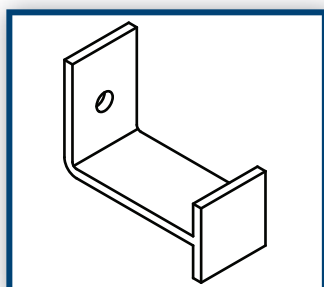

**STA-09:**  
"L" ANCHOR WITH WELDED TAB

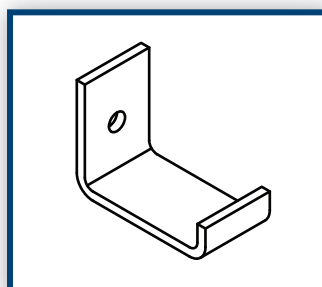

**STA-10:**  
"J" ANCHOR

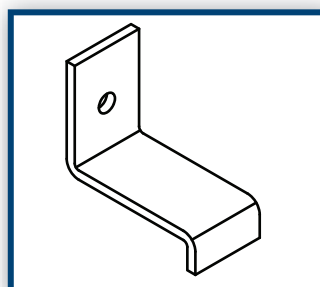

**STA-11:**  
"Z" ANCHOR

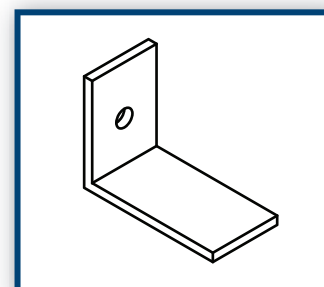

**STA-12:**  
CLIP ANGLE

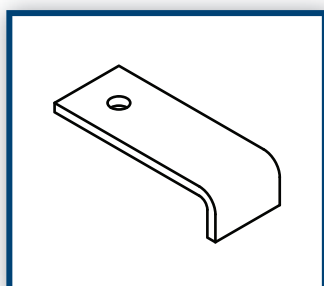

**STA-13:**  
"L" STRAP ANCHOR

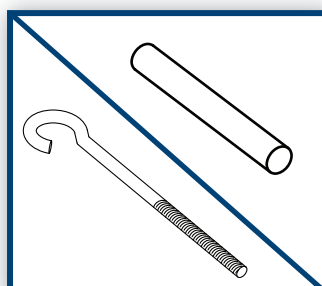

**STA-14:**  
EYE BOLT THREADED

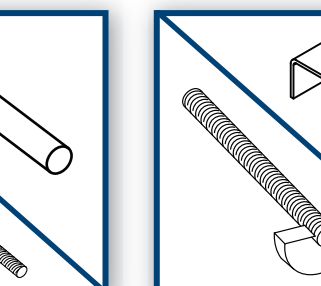

**STA-15:**  
DOWEL

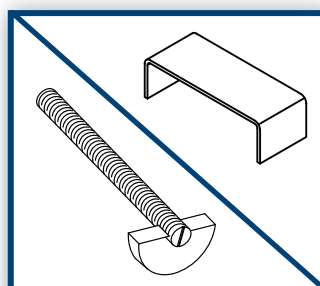

**STA-16:**  
THREADED HALF MOON "U" ANCHOR

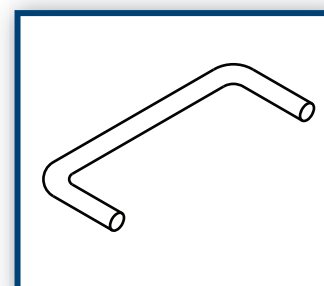

**STA-17:**  
"U" BOLT

# STA-01: "L" ANCHOR WITH WELDED PIN

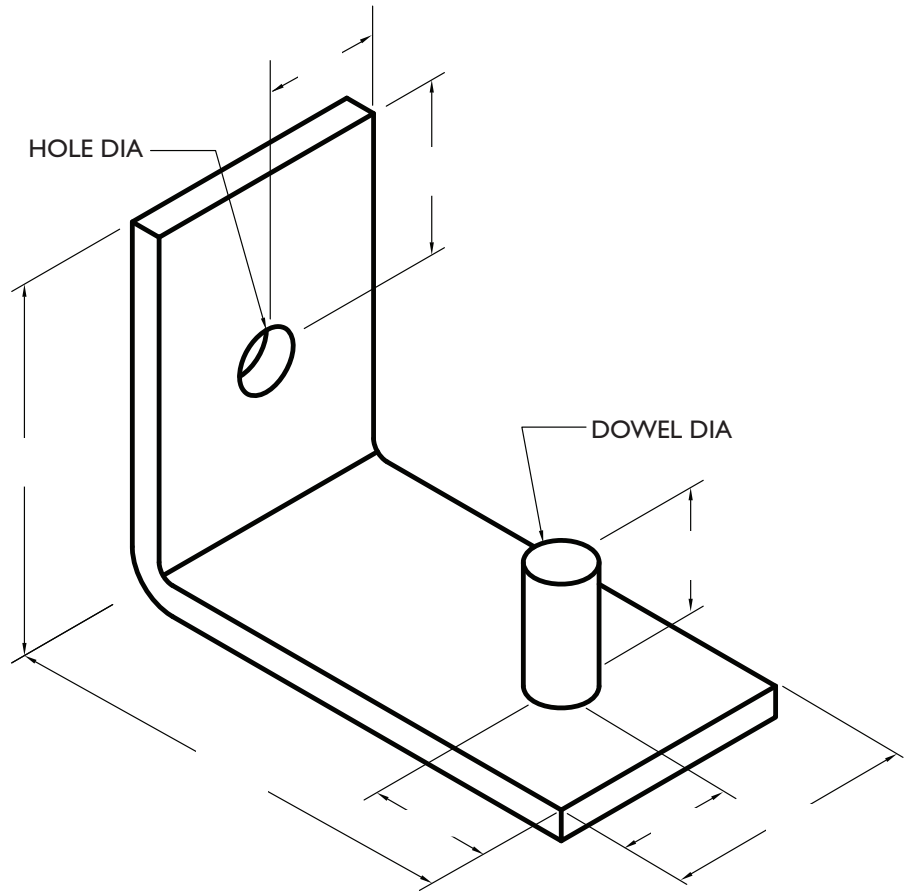

Suggested items to go with this anchor:

- Concrete screws
- Self tapping metal screws
- Expansion bolts
- Epoxy adhesive
- Plastic shims

**ST/ST Plate Min. Fy = 45,000 p.s.i. (ASTM A666)**  
**ST/ST Rounds Min. Fy = 75,000 p.s.i. (ASTM A580)**

DRAWING FOR ILLUSTRATIVE PURPOSES ONLY

## THICKNESS:

\_\_\_ 1/8"  
 \_\_\_ 3/16"  
 \_\_\_ 1/4"  
 \_\_\_ Other: \_\_\_\_\_

## WIDTH:

\_\_\_ 1"  
 \_\_\_ 1 1/4"  
 \_\_\_ 1 1/2"  
 \_\_\_ 2"  
 \_\_\_ 2 1/2"  
 \_\_\_ Other: \_\_\_\_\_

## FINISH:

\_\_\_ Stainless Steel Type 304  
 \_\_\_ Stainless Steel Type 316

**Customer:** \_\_\_\_\_

**Contact:** \_\_\_\_\_

**Phone:** \_\_\_\_\_

**Job Name:** \_\_\_\_\_

**Quantity:**

Please copy, complete form and fax back to 631.920.2343

**IMPORTANT:** Since every project is unique, the selection and use of an anchor system or any part there of must be determined by competent architects, engineers and/or other appropriate professionals who are familiar with the specific requirements of the project where these specific items are being used.

©2012 Corinthian Cast Stone, Inc. All rights reserved.

# STA-02: "L" ANCHOR WITH WELDED PIN

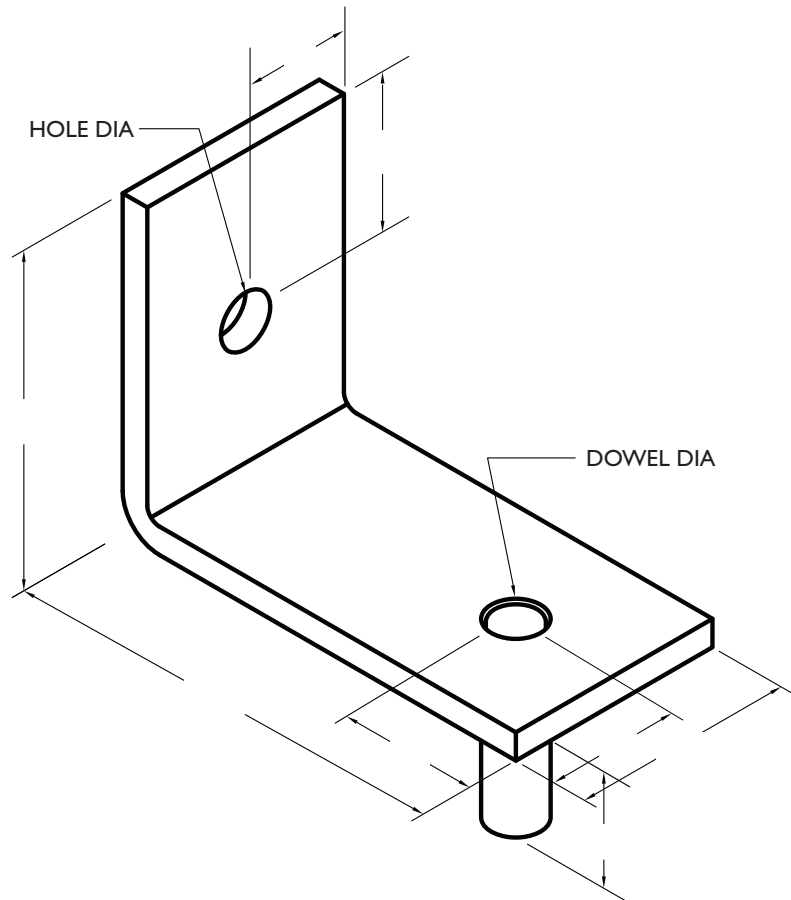

Suggested items to go with this anchor:

- Concrete screws
- Self tapping metal screws
- Expansion bolts
- Epoxy adhesive
- Plastic shims

**ST/ST Plate Min. Fy = 45,000 p.s.i. (ASTM A666)**  
**ST/ST Rounds Min. Fy = 75,000 p.s.i. (ASTM A580)**

**DRAWING FOR ILLUSTRATIVE PURPOSES ONLY**

## THICKNESS:

\_\_\_ 1/8"  
 \_\_\_ 3/16"  
 \_\_\_ 1/4"  
 \_\_\_ Other: \_\_\_\_\_

## WIDTH:

\_\_\_ 1"  
 \_\_\_ 1 1/4"  
 \_\_\_ 1 1/2"  
 \_\_\_ 2"  
 \_\_\_ 2 1/2"  
 \_\_\_ Other: \_\_\_\_\_

## FINISH:

\_\_\_ Stainless Steel Type 304  
 \_\_\_ Stainless Steel Type 316

**Customer:** \_\_\_\_\_

**Contact:** \_\_\_\_\_

**Phone:** \_\_\_\_\_

**Job Name:** \_\_\_\_\_

**Quantity:**

Please complete form and fax back to 631.920.2343

**IMPORTANT:** Since every project is unique, the selection and use of an anchor system or any part there of must be determined by competent architects, engineers and/or other appropriate professionals who are familiar with the specific requirements of the project where these specific items are being used.

©2012 Corinthian Cast Stone, Inc. All rights reserved.

# STA-03: "L" ANCHOR WITH PIN

## Dowel:

☐ Loose  
☐ Welded

Suggested items to go with this anchor:

- Concrete screws
- Self tapping metal screws
- Expansion bolts
- Epoxy adhesive
- Plastic shims

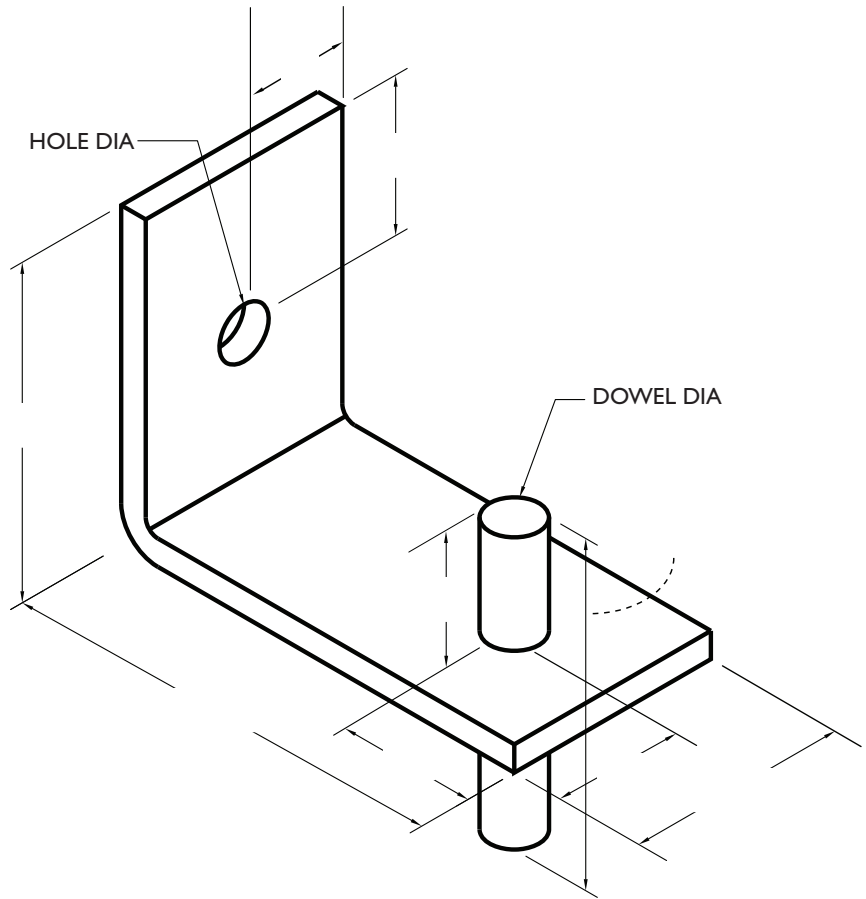

**ST/ST Plate Min. Fy = 45,000 p.s.i. (ASTM A666)**  
**ST/ST Rounds Min. Fy = 75,000 p.s.i. (ASTM A580)**

DRAWING FOR ILLUSTRATIVE PURPOSES ONLY

### THICKNESS:

☐ 1/8"  
☐ 3/16"  
☐ 1/4"  
☐ Other: \_\_\_\_\_

### WIDTH:

☐ 1"  
☐ 1 1/4"  
☐ 1 1/2"  
☐ 2"  
☐ 2 1/2"  
☐ Other: \_\_\_\_\_

### FINISH:

☐ Stainless Steel Type 304  
☐ Stainless Steel Type 316

Customer: \_\_\_\_\_

Contact: \_\_\_\_\_

Phone: \_\_\_\_\_

Job Name: \_\_\_\_\_

Quantity:

Please copy, complete form and fax back to 631.920.2343

**IMPORTANT:** Since every project is unique, the selection and use of an anchor system or any part there of must be determined by competent architects, engineers and/or other appropriate professionals who are familiar with the specific requirements of the project where these specific items are being used.

©2012 Corinthian Cast Stone, Inc. All rights reserved.



# STA-04: FLATSTOCK WITH WELDED PIN

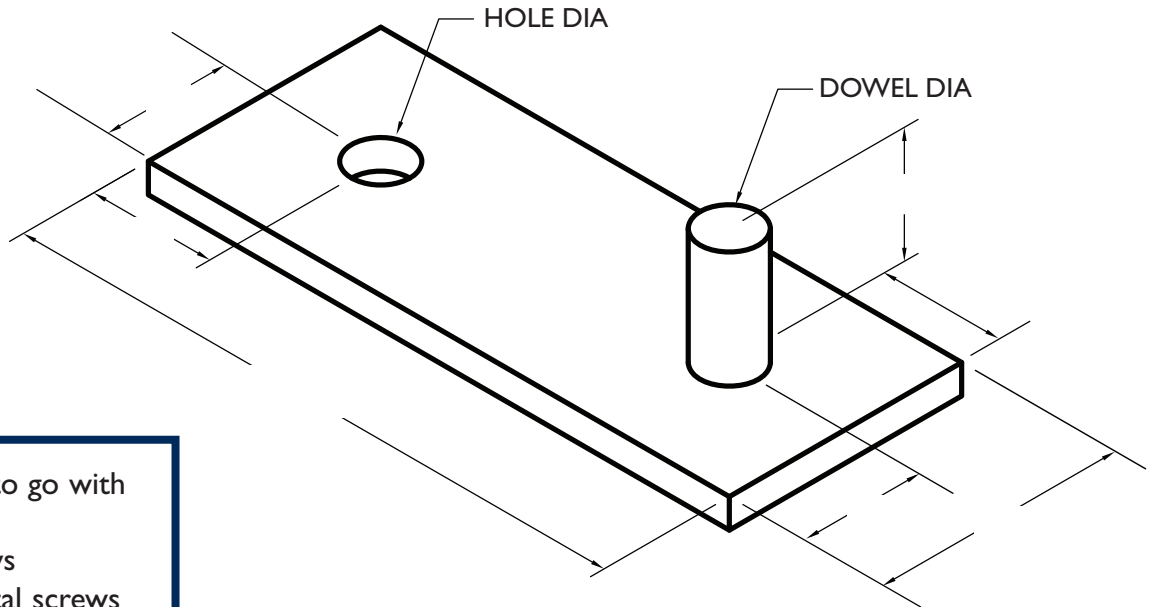

Suggested items to go with this anchor:

- Concrete screws
- Self tapping metal screws
- Expansion bolts
- Epoxy adhesive
- Plastic shims

**ST/ST Plate Min. Fy. = 45,000 p.s.i. (ASTM A666)**  
**ST/ST Rounds Min. Fy. = 75,000 p.s.i. (ASTM A580)**

**DRAWING FOR ILLUSTRATIVE PURPOSES ONLY**

## THICKNESS:

\_\_\_ 1/8"  
 \_\_\_ 3/16"  
 \_\_\_ 1/4"  
 \_\_\_ Other: \_\_\_\_\_

## WIDTH:

\_\_\_ 1"  
 \_\_\_ 1 1/4"  
 \_\_\_ 1 1/2"  
 \_\_\_ 2"  
 \_\_\_ 2 1/2"  
 \_\_\_ Other: \_\_\_\_\_

## FINISH:

\_\_\_ Stainless Steel Type 304  
 \_\_\_ Stainless Steel Type 316

**Customer:** \_\_\_\_\_

**Contact:** \_\_\_\_\_

**Phone:** \_\_\_\_\_

**Job Name:** \_\_\_\_\_

**Quantity:**

Please copy, complete form and fax back to 631.920.2343

**IMPORTANT:** Since every project is unique, the selection and use of an anchor system or any part there of must be determined by competent architects, engineers and/or other appropriate professionals who are familiar with the specific requirements of the project where these specific items are being used.

©2012 Corinthian Cast Stone, Inc. All rights reserved.



# STA-05: FLATSTOCK WITH PIN

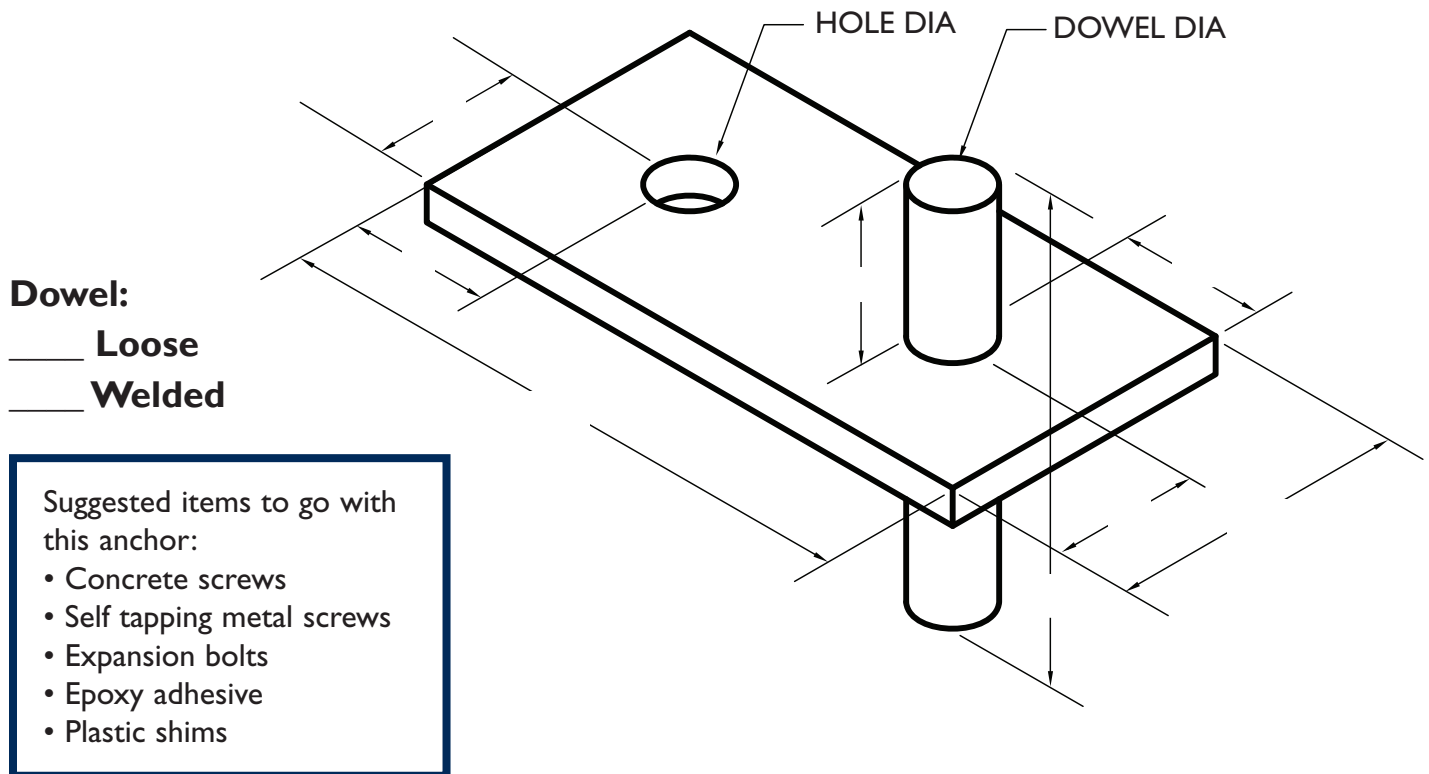

**ST/ST Plate Min. Fy = 45,000 p.s.i. (ASTM A666)**  
**ST/ST Rounds Min. Fy = 75,000 p.s.i. (ASTM A580)**

**DRAWING FOR ILLUSTRATIVE PURPOSES ONLY**

<p><b>THICKNESS:</b></p> <p><input type="checkbox"/> 1/8"</p> <p><input type="checkbox"/> 3/16"</p> <p><input type="checkbox"/> 1/4"</p> <p><input type="checkbox"/> Other: _____</p> <p><b>WIDTH:</b></p> <p><input type="checkbox"/> 1"</p> <p><input type="checkbox"/> 1 1/4"</p> <p><input type="checkbox"/> 1 1/2"</p> <p><input type="checkbox"/> 2"</p> <p><input type="checkbox"/> 2 1/2"</p> <p><input type="checkbox"/> Other: _____</p> <p><b>FINISH:</b></p> <p><input type="checkbox"/> Stainless Steel Type 304</p> <p><input type="checkbox"/> Stainless Steel Type 316</p>	<p><b>Customer:</b> _____</p> <p><b>Contact:</b> _____</p> <p><b>Phone:</b> _____</p> <p><b>Job Name:</b> _____</p> <p><b>Quantity:</b> <input type="text"/></p> <p>Please copy, complete form and fax back to 631.920.2343</p>
--------------------------------------------------------------------------------------------------------------------------------------------------------------------------------------------------------------------------------------------------------------------------------------------------------------------------------------------------------------------------------------------------------------------------------------------------------------------------------------------------------------------------------------------------------------------------------------------	---------------------------------------------------------------------------------------------------------------------------------------------------------------------------------------------------------------------------------

**IMPORTANT:** Since every project is unique, the selection and use of an anchor system or any part there of must be determined by competent architects, engineers and/or other appropriate professionals who are familiar with the specific requirements of the project where these specific items are being used.

©2012 Corinthian Cast Stone, Inc. All rights reserved.

# STA-06: SPLIT TAIL

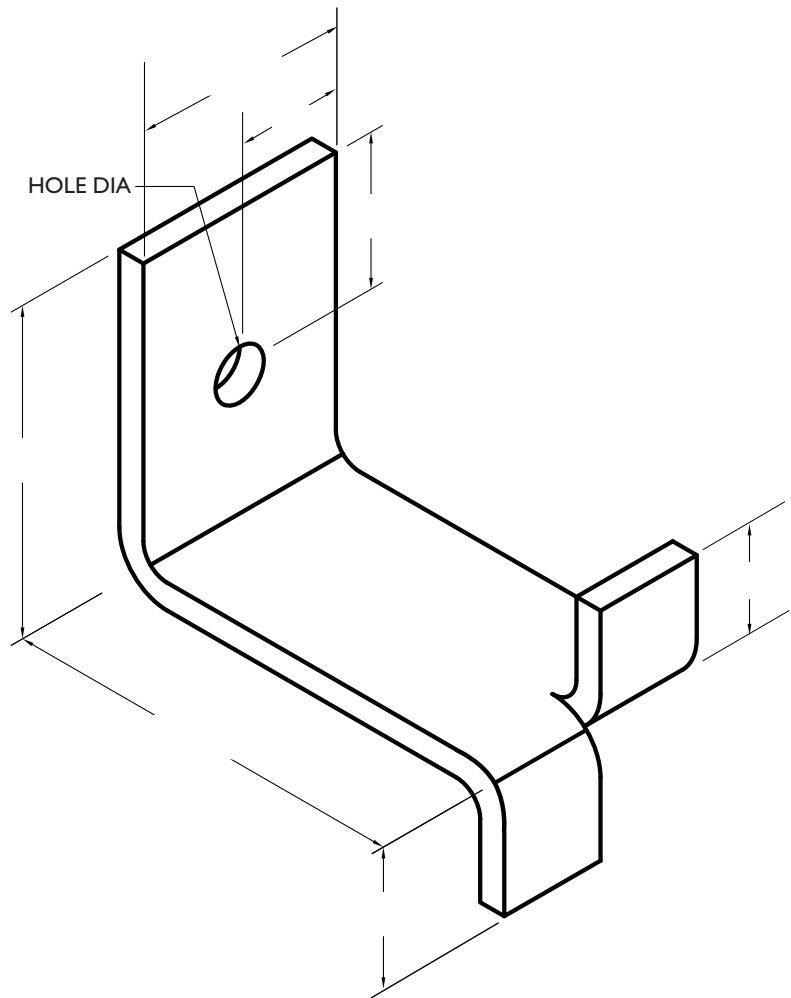

Suggested items to go with this anchor:

- Concrete screws
- Self tapping metal screws
- Expansion bolts
- Epoxy adhesive
- Plastic shims

**ST/ST Plate Min. Fy. = 45,000 p.s.i. (ASTM A666)**  
**ST/ST Rounds Min. Fy. = 75,000 p.s.i. (ASTM A580)**

DRAWING FOR ILLUSTRATIVE PURPOSES ONLY

## THICKNESS:

\_\_\_ 1/8"  
 \_\_\_ 3/16"  
 \_\_\_ 1/4"  
 \_\_\_ Other: \_\_\_\_\_

## WIDTH:

\_\_\_ 1"  
 \_\_\_ 1 1/4"  
 \_\_\_ 1 1/2"  
 \_\_\_ 2"  
 \_\_\_ 2 1/2"  
 \_\_\_ Other: \_\_\_\_\_

## FINISH:

\_\_\_ Stainless Steel Type 304  
 \_\_\_ Stainless Steel Type 316

**Customer:** \_\_\_\_\_

**Contact:** \_\_\_\_\_

**Phone:** \_\_\_\_\_

**Job Name:** \_\_\_\_\_

**Quantity:**

Please copy, complete form and fax back to 631.920.2343

**IMPORTANT:** Since every project is unique, the selection and use of an anchor system or any part there of must be determined by competent architects, engineers and/or other appropriate professionals who are familiar with the specific requirements of the project where these specific items are being used.

©2012 Corinthian Cast Stone, Inc. All rights reserved.

# STA-07: SPLIT TAIL

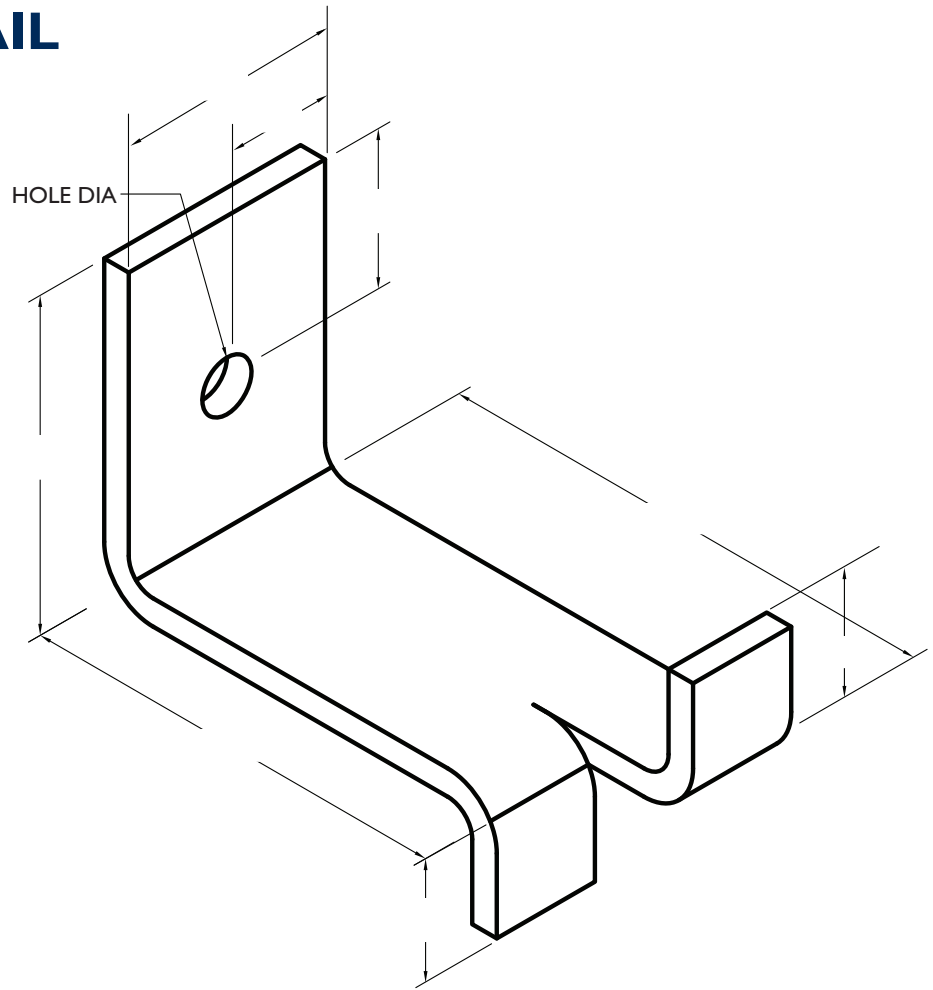

Suggested items to go with this anchor:

- Concrete screws
- Self tapping metal screws
- Expansion bolts
- Epoxy adhesive
- Plastic shims

**ST/ST Plate Min. Fy. = 45,000 p.s.i. (ASTM A666)**  
**ST/ST Rounds Min. Fy. = 75,000 p.s.i. (ASTM A580)**

**DRAWING FOR ILLUSTRATIVE PURPOSES ONLY**

## THICKNESS:

\_\_\_ 1/8"  
 \_\_\_ 3/16"  
 \_\_\_ 1/4"  
 \_\_\_ Other: \_\_\_\_\_

## WIDTH:

\_\_\_ 1"  
 \_\_\_ 1 1/4"  
 \_\_\_ 1 1/2"  
 \_\_\_ 2"  
 \_\_\_ 2 1/2"  
 \_\_\_ Other: \_\_\_\_\_

## FINISH:

\_\_\_ Stainless Steel Type 304  
 \_\_\_ Stainless Steel Type 316

**Customer:** \_\_\_\_\_

**Contact:** \_\_\_\_\_

**Phone:** \_\_\_\_\_

**Job Name:** \_\_\_\_\_

**Quantity:**

Please copy, complete form and fax back to 631.920.2343

**IMPORTANT:** Since every project is unique, the selection and use of an anchor system or any part there of must be determined by competent architects, engineers and/or other appropriate professionals who are familiar with the specific requirements of the project where these specific items are being used.

©2012 Corinthian Cast Stone, Inc. All rights reserved.

# STA-08: SPLIT TAIL

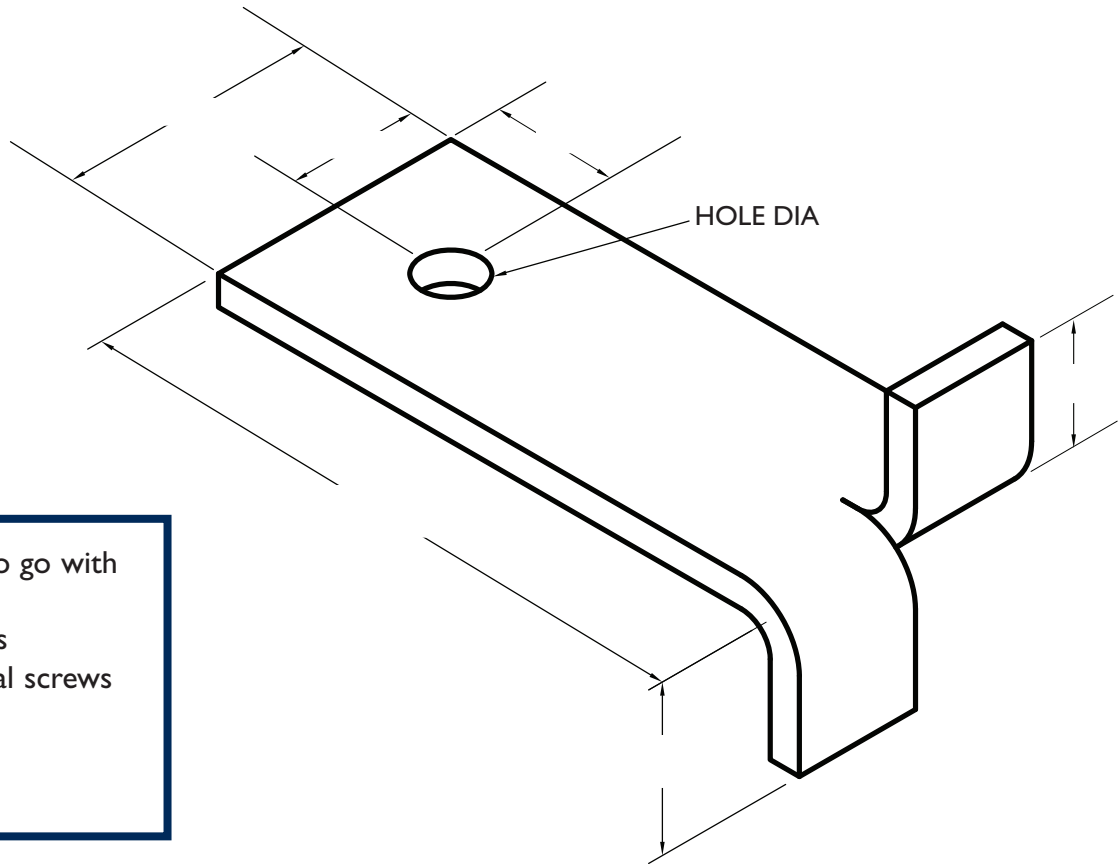

Suggested items to go with this anchor:

- Concrete screws
- Self tapping metal screws
- Expansion bolts
- Epoxy adhesive
- Plastic shims

**ST/ST Plate Min. Fy. = 45,000 p.s.i. (ASTM A666)**  
**ST/ST Rounds Min. Fy. = 75,000 p.s.i. (ASTM A580)**

**DRAWING FOR ILLUSTRATIVE PURPOSES ONLY**

## THICKNESS:

\_\_\_ 1/8"  
 \_\_\_ 3/16"  
 \_\_\_ 1/4"  
 \_\_\_ Other: \_\_\_\_\_

## WIDTH:

\_\_\_ 1"  
 \_\_\_ 1 1/4"  
 \_\_\_ 1 1/2"  
 \_\_\_ 2"  
 \_\_\_ 2 1/2"  
 \_\_\_ Other: \_\_\_\_\_

## FINISH:

\_\_\_ Stainless Steel Type 304  
 \_\_\_ Stainless Steel Type 316

**Customer:** \_\_\_\_\_

**Contact:** \_\_\_\_\_

**Phone:** \_\_\_\_\_

**Job Name:** \_\_\_\_\_

**Quantity:**

Please copy, complete form and fax back to 631.920.2343

**IMPORTANT:** Since every project is unique, the selection and use of an anchor system or any part there of must be determined by competent architects, engineers and/or other appropriate professionals who are familiar with the specific requirements of the project where these specific items are being used.

©2012 Corinthian Cast Stone, Inc. All rights reserved.



# STA-09: ANCHOR WITH WELDED TAB

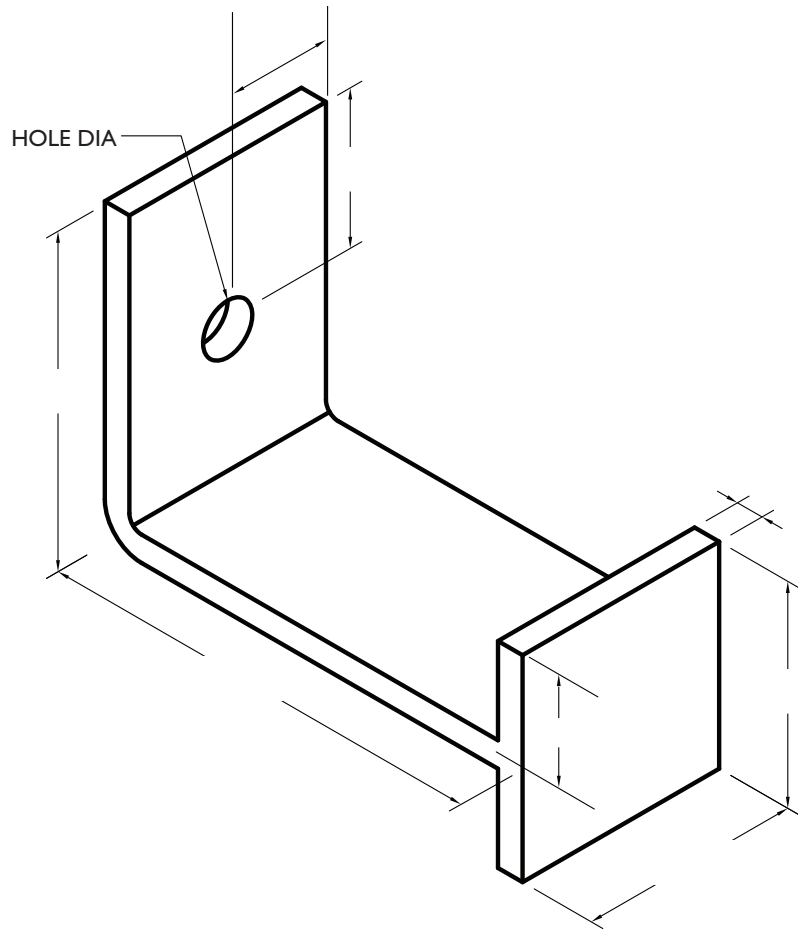

Suggested items to go with this anchor:

- Concrete screws
- Self tapping metal screws
- Expansion bolts
- Epoxy adhesive
- Plastic shims

**ST/ST Plate Min. Fy. = 45,000 p.s.i. (ASTM A666)**  
**ST/ST Rounds Min. Fy. = 75,000 p.s.i. (ASTM A580)**

DRAWING FOR ILLUSTRATIVE PURPOSES ONLY

## THICKNESS:

\_\_\_ 1/8"  
 \_\_\_ 3/16"  
 \_\_\_ 1/4"  
 \_\_\_ Other: \_\_\_\_\_

## WIDTH:

\_\_\_ 1"  
 \_\_\_ 1 1/4"  
 \_\_\_ 1 1/2"  
 \_\_\_ 2"  
 \_\_\_ 2 1/2"  
 \_\_\_ Other: \_\_\_\_\_

## FINISH:

\_\_\_ Stainless Steel Type 304  
 \_\_\_ Stainless Steel Type 316

**Customer:** \_\_\_\_\_

**Contact:** \_\_\_\_\_

**Phone:** \_\_\_\_\_

**Job Name:** \_\_\_\_\_

**Quantity:**

Please copy, complete form and fax back to 631.920.2343

**IMPORTANT:** Since every project is unique, the selection and use of an anchor system or any part there of must be determined by competent architects, engineers and/or other appropriate professionals who are familiar with the specific requirements of the project where these specific items are being used.

©2012 Corinthian Cast Stone, Inc. All rights reserved.

# STA-10: "J" ANCHOR

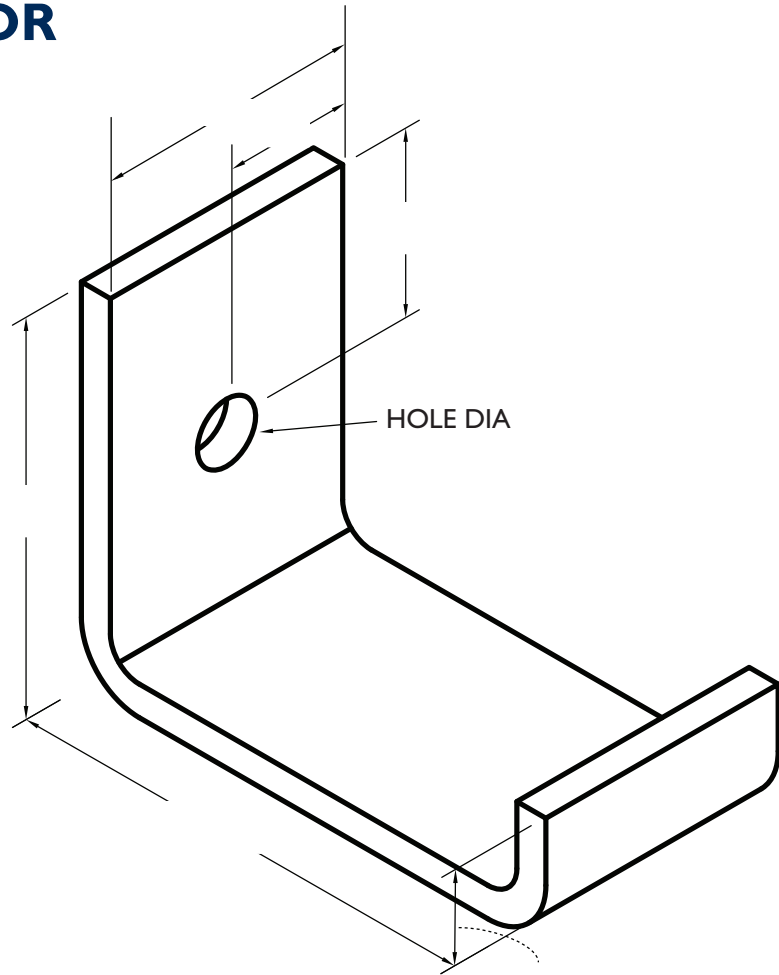

Suggested items to go with this anchor:

- Concrete screws
- Self tapping metal screws
- Expansion bolts
- Epoxy adhesive
- Plastic shims

**ST/ST Plate Min. Fy = 45,000 p.s.i. (ASTM A666)**  
**ST/ST Rounds Min. Fy = 75,000 p.s.i. (ASTM A580)**

DRAWING FOR ILLUSTRATIVE PURPOSES ONLY

## THICKNESS:

\_\_\_ 1/8"  
 \_\_\_ 3/16"  
 \_\_\_ 1/4"  
 \_\_\_ Other: \_\_\_\_\_

## WIDTH:

\_\_\_ 1"  
 \_\_\_ 1 1/4"  
 \_\_\_ 1 1/2"  
 \_\_\_ 2"  
 \_\_\_ 2 1/2"  
 \_\_\_ Other: \_\_\_\_\_

## FINISH:

\_\_\_ Stainless Steel Type 304  
 \_\_\_ Stainless Steel Type 316

**Customer:** \_\_\_\_\_

**Contact:** \_\_\_\_\_

**Phone:** \_\_\_\_\_

**Job Name:** \_\_\_\_\_

**Quantity:**

Please copy, complete form and fax back to 631.920.2343

**IMPORTANT:** Since every project is unique, the selection and use of an anchor system or any part there of must be determined by competent architects, engineers and/or other appropriate professionals who are familiar with the specific requirements of the project where these specific items are being used.

©2012 Corinthian Cast Stone, Inc. All rights reserved.

# STA-11: "Z" ANCHOR

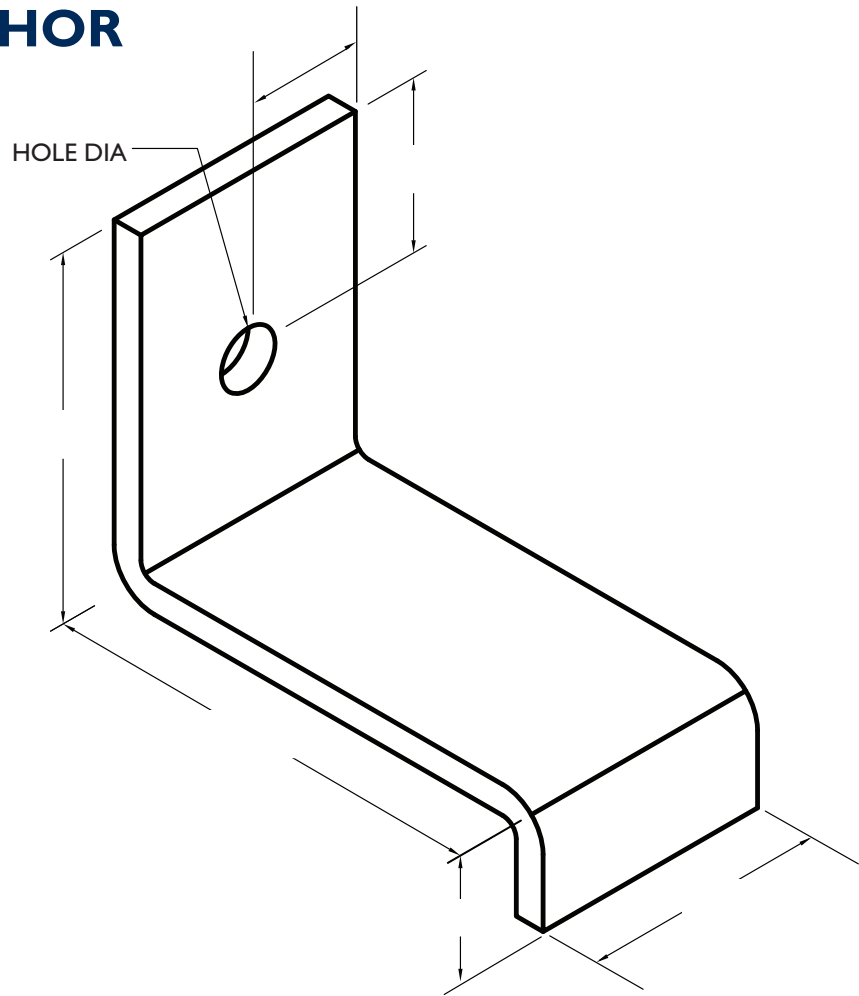

Suggested items to go with this anchor:

- Concrete screws
- Self tapping metal screws
- Expansion bolts
- Epoxy adhesive
- Plastic shims

**ST/ST Plate Min. Fy = 45,000 p.s.i. (ASTM A666)**  
**ST/ST Rounds Min. Fy = 75,000 p.s.i. (ASTM A580)**

DRAWING FOR ILLUSTRATIVE PURPOSES ONLY

## THICKNESS:

☐ 1/8"  
☐ 3/16"  
☐ 1/4"  
☐ Other: \_\_\_\_\_

## WIDTH:

☐ 1"  
☐ 1 1/4"  
☐ 1 1/2"  
☐ 2"  
☐ 2 1/2"  
☐ Other: \_\_\_\_\_

## FINISH:

☐ Stainless Steel Type 304  
☐ Stainless Steel Type 316

**Customer:** \_\_\_\_\_

**Contact:** \_\_\_\_\_

**Phone:** \_\_\_\_\_

**Job Name:** \_\_\_\_\_

**Quantity:**

Please copy, complete form and fax back to 631.920.2343

**IMPORTANT:** Since every project is unique, the selection and use of an anchor system or any part there of must be determined by competent architects, engineers and/or other appropriate professionals who are familiar with the specific requirements of the project where these specific items are being used.

©2012 Corinthian Cast Stone, Inc. All rights reserved.

# STA-12: CLIP ANGLE

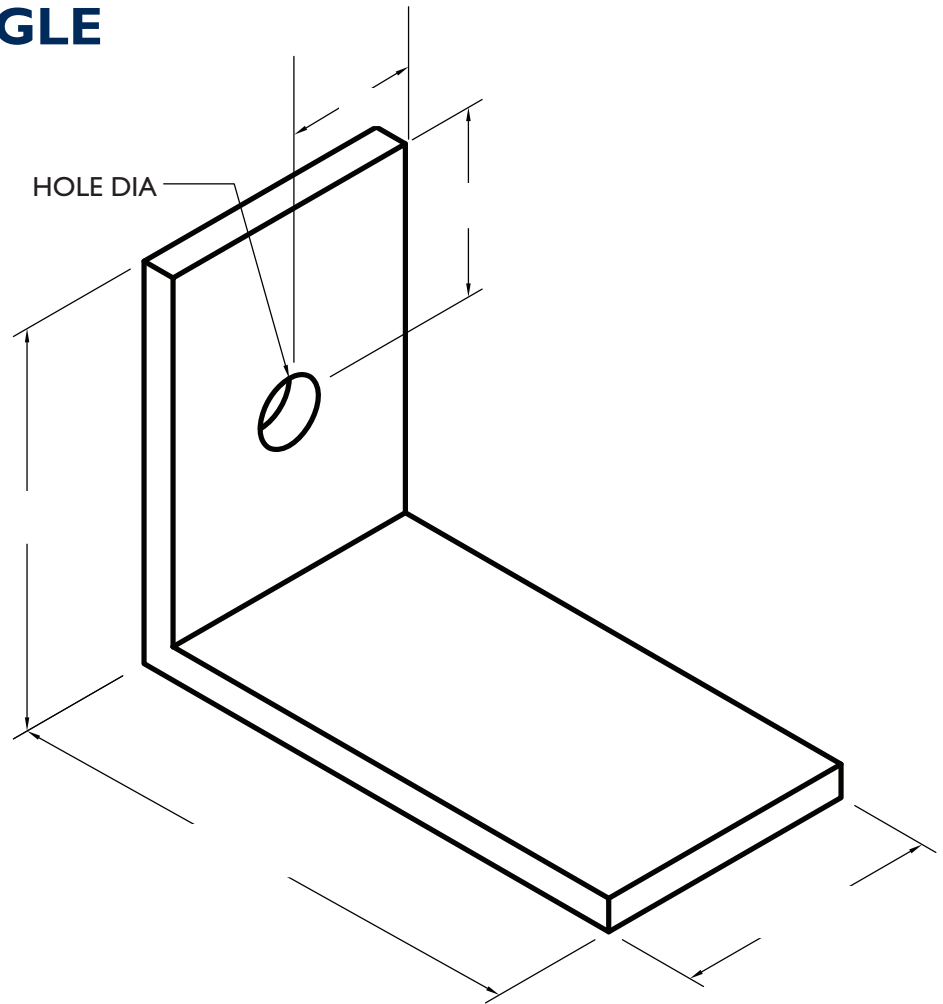

Suggested items to go with this anchor:

- Concrete screws
- Self tapping metal screws
- Expansion bolts
- Epoxy adhesive
- Plastic shims

**ST/ST Plate Min. Fy. = 45,000 p.s.i. (ASTM A666)**  
**ST/ST Rounds Min. Fy. = 75,000 p.s.i. (ASTM A580)**

DRAWING FOR ILLUSTRATIVE PURPOSES ONLY

## THICKNESS:

☐ 1/8"  
☐ 3/16"  
☐ 1/4"  
☐ Other: \_\_\_\_\_

## WIDTH:

☐ 1"  
☐ 1 1/4"  
☐ 1 1/2"  
☐ 2"  
☐ 2 1/2"  
☐ Other: \_\_\_\_\_

## FINISH:

☐ Stainless Steel Type 304  
☐ Stainless Steel Type 316

**Customer:** \_\_\_\_\_

**Contact:** \_\_\_\_\_

**Phone:** \_\_\_\_\_

**Job Name:** \_\_\_\_\_

**Quantity:**

Please copy, complete form and fax back to 631.920.2343

**IMPORTANT:** Since every project is unique, the selection and use of an anchor system or any part there of must be determined by competent architects, engineers and/or other appropriate professionals who are familiar with the specific requirements of the project where these specific items are being used.

©2012 Corinthian Cast Stone, Inc. All rights reserved.



# STA-13: FLATSTOCK WITH PIN

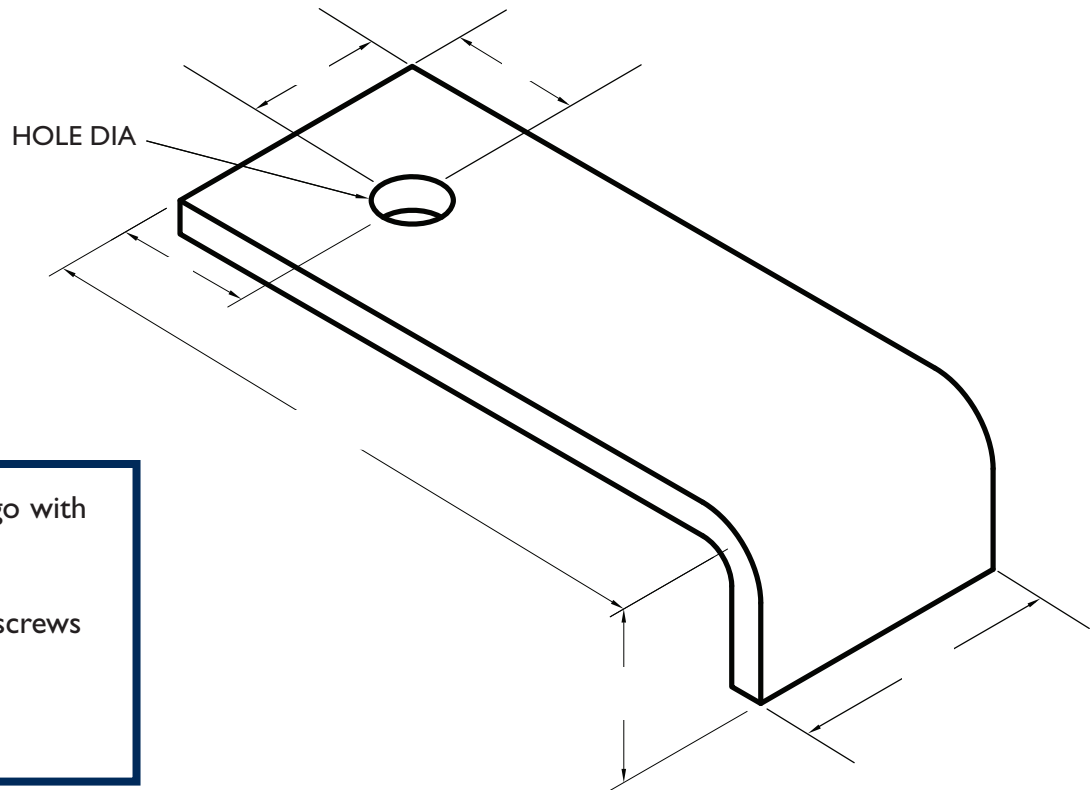

Suggested items to go with this anchor:

- Concrete screws
- Self tapping metal screws
- Expansion bolts
- Epoxy adhesive
- Plastic shims

**ST/ST Plate Min. Fy = 45,000 p.s.i. (ASTM A666)**  
**ST/ST Rounds Min. Fy = 75,000 p.s.i. (ASTM A580)**

DRAWING FOR ILLUSTRATIVE PURPOSES ONLY

## THICKNESS:

\_\_\_ 1/8"  
\_\_\_ 3/16"  
\_\_\_ 1/4"  
\_\_\_ Other: \_\_\_\_\_

## WIDTH:

\_\_\_ 1"  
\_\_\_ 1 1/4"  
\_\_\_ 1 1/2"  
\_\_\_ 2"  
\_\_\_ 2 1/2"  
\_\_\_ Other: \_\_\_\_\_

## FINISH:

\_\_\_ Stainless Steel Type 304  
\_\_\_ Stainless Steel Type 316

**Customer:** \_\_\_\_\_

**Contact:** \_\_\_\_\_

**Phone:** \_\_\_\_\_

**Job Name:** \_\_\_\_\_

**Quantity:**

Please copy, complete form and fax back to 631.920.2343

**IMPORTANT:** Since every project is unique, the selection and use of an anchor system or any part there of must be determined by competent architects, engineers and/or other appropriate professionals who are familiar with the specific requirements of the project where these specific items are being used.

©2012 Corinthian Cast Stone, Inc. All rights reserved.

# STA-14: EYE BOLT-THREADED

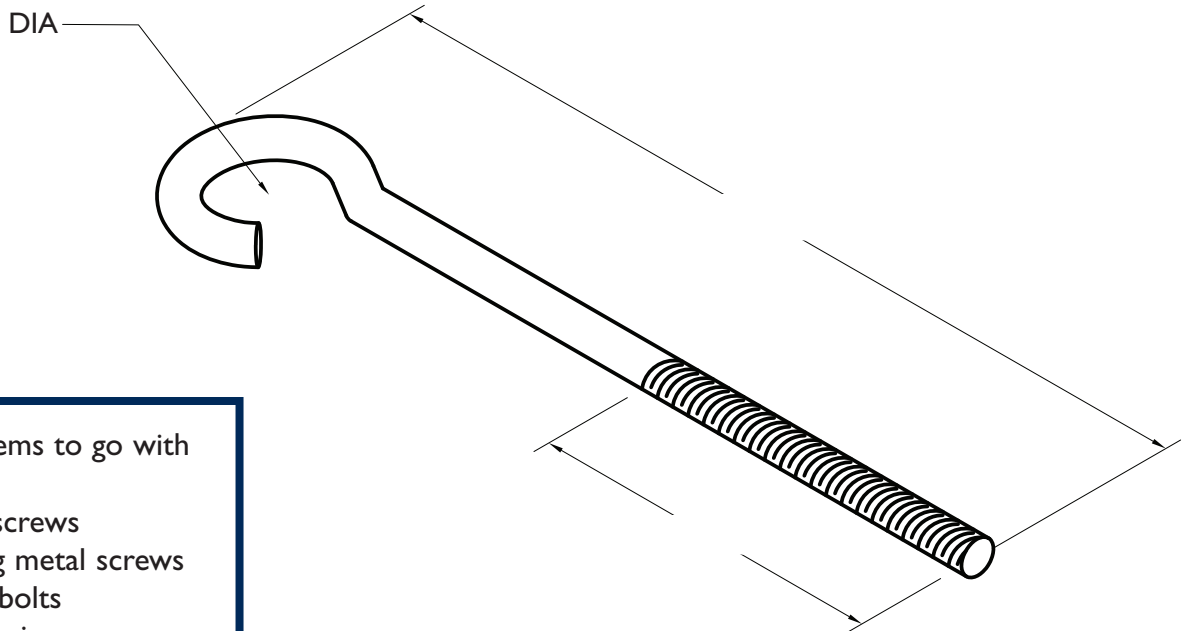

Suggested items to go with this anchor:

- Concrete screws
- Self tapping metal screws
- Expansion bolts
- Epoxy adhesive
- Plastic shims

**ST/ST Plate Min. Fy. = 45,000 p.s.i. (ASTM A666)**  
**ST/ST Rounds Min. Fy. = 75,000 p.s.i. (ASTM A580)**

DRAWING FOR ILLUSTRATIVE PURPOSES ONLY

## DIAMETER:

☐ 1/4"                      ☐ 1/2"  
☐ 5/16"                    ☐ 5/8"  
☐ 3/8"                      ☐ 3/4"  
                                ☐ 1"  
                                ☐ Other: \_\_\_\_\_

## FINISH:

☐ Stainless Steel Type 304  
☐ Stainless Steel Type 316

**Customer:** \_\_\_\_\_

**Contact:** \_\_\_\_\_

**Phone:** \_\_\_\_\_

**Job Name:** \_\_\_\_\_

**Quantity:**

Please copy, complete form and fax back to 631.920.2343

**IMPORTANT:** Since every project is unique, the selection and use of an anchor system or any part there of must be determined by competent architects, engineers and/or other appropriate professionals who are familiar with the specific requirements of the project where these specific items are being used.

©2012 Corinthian Cast Stone, Inc. All rights reserved.

# STA-15: DOWEL

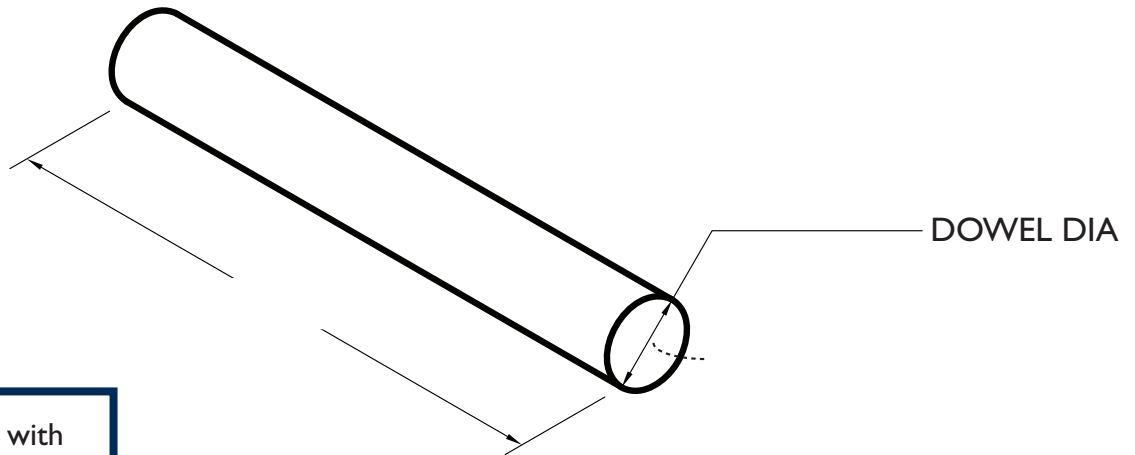

Suggested items to go with this anchor:

- Concrete screws
- Self tapping metal screws
- Expansion bolts
- Epoxy adhesive
- Plastic shims

\_\_\_ Threaded  
\_\_\_ Smooth

**ST/ST Plate Min. Fy. = 45,000 p.s.i. (ASTM A666)**  
**ST/ST Rounds Min. Fy. = 75,000 p.s.i. (ASTM A580)**

DRAWING FOR ILLUSTRATIVE PURPOSES ONLY

## DIAMETER:

\_\_\_ 3/16"                      \_\_\_ 1/2"  
\_\_\_ 1/4"                      \_\_\_ 5/8"  
\_\_\_ 5/16"                     \_\_\_ 3/4"  
\_\_\_ 3/8"                      \_\_\_ Other: \_\_\_\_\_  
\_\_\_ Other: \_\_\_\_\_

## FINISH:

\_\_\_ Stainless Steel Type 304  
\_\_\_ Stainless Steel Type 316

Customer: \_\_\_\_\_

Contact: \_\_\_\_\_

Phone: \_\_\_\_\_

Job Name: \_\_\_\_\_

Quantity:

Please copy, complete form and fax back to 631.920.2343

**IMPORTANT:** Since every project is unique, the selection and use of an anchor system or any part there of must be determined by competent architects, engineers and/or other appropriate professionals who are familiar with the specific requirements of the project where these specific items are being used.

©2012 Corinthian Cast Stone, Inc. All rights reserved.

# STA-16: THREADED HALF MOON

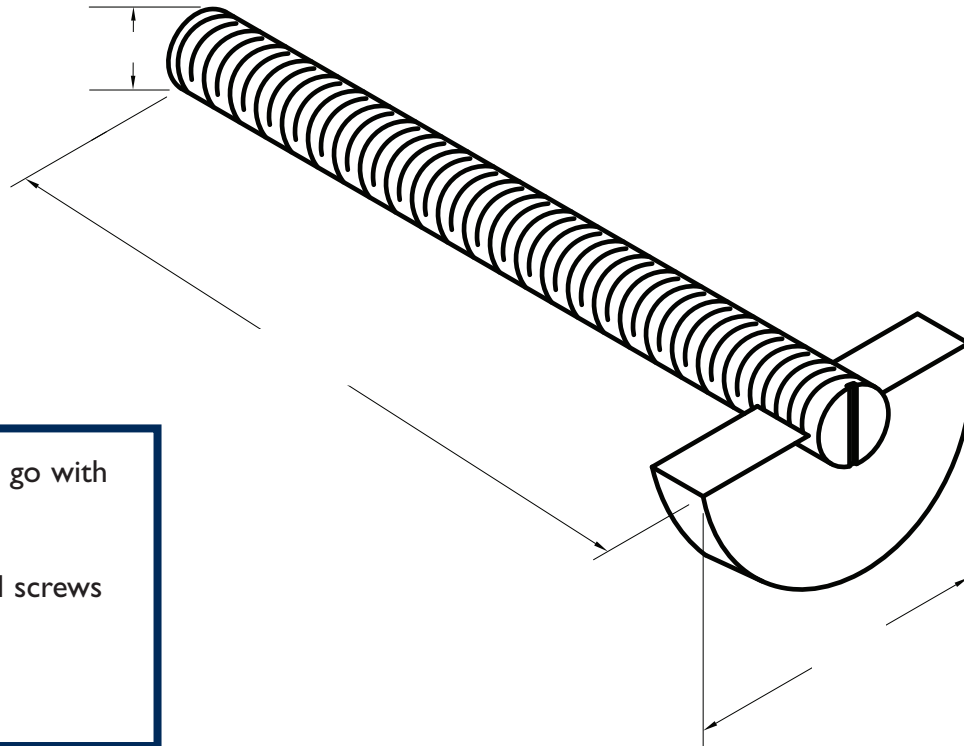

Suggested items to go with this anchor:

- Concrete screws
- Self tapping metal screws
- Expansion bolts
- Epoxy adhesive
- Plastic shims

**ST/ST Plate Min. Fy = 45,000 p.s.i. (ASTM A666)**  
**ST/ST Rounds Min. Fy = 75,000 p.s.i. (ASTM A580)**

DRAWING FOR ILLUSTRATIVE PURPOSES ONLY

## DIAMETER:

☐ 1/4"                      ☐ 1/2"  
☐ 5/16"                   ☐ 5/8"  
☐ 3/8"                      ☐ 3/4"  
☐ Other: \_\_\_\_\_

## FINISH:

☐ Stainless Steel Type 304  
☐ Stainless Steel Type 316

**Customer:** \_\_\_\_\_

**Contact:** \_\_\_\_\_

**Phone:** \_\_\_\_\_

**Job Name:** \_\_\_\_\_

**Quantity:**

Please copy, complete form and fax back to 631.920.2343

**IMPORTANT:** Since every project is unique, the selection and use of an anchor system or any part there of must be determined by competent architects, engineers and/or other appropriate professionals who are familiar with the specific requirements of the project where these specific items are being used.

©2012 Corinthian Cast Stone, Inc. All rights reserved.



# STA-17: "U" ANCHOR

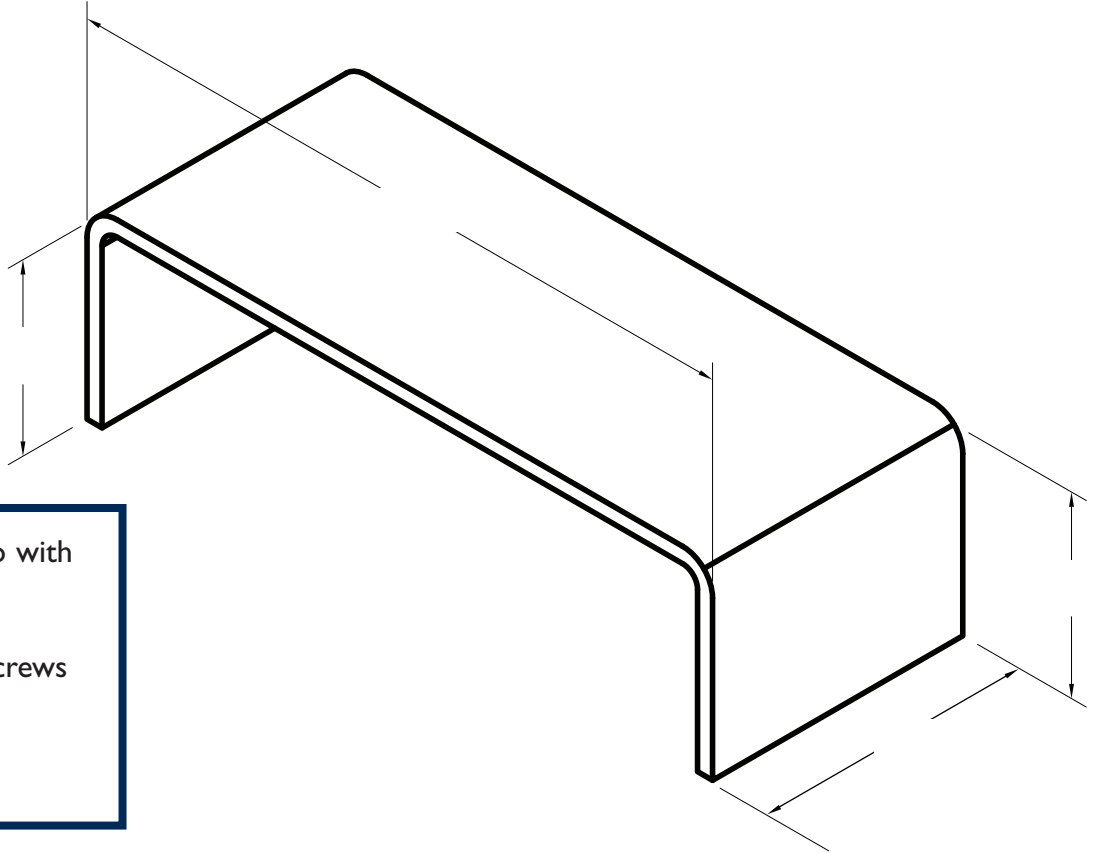

Suggested items to go with this anchor:

- Concrete screws
- Self tapping metal screws
- Expansion bolts
- Epoxy adhesive
- Plastic shims

**ST/ST Plate Min. Fy. = 45,000 p.s.i. (ASTM A666)**  
**ST/ST Rounds Min. Fy. = 75,000 p.s.i. (ASTM A580)**

**DRAWING FOR ILLUSTRATIVE PURPOSES ONLY**

## THICKNESS:

☐ 1/8"  
☐ 3/16"  
☐ 1/4"  
☐ Other: \_\_\_\_\_

## WIDTH:

☐ 1"  
☐ 1 1/4"  
☐ 1 1/2"  
☐ 2"  
☐ 2 1/2"  
☐ Other: \_\_\_\_\_

## FINISH:

☐ Stainless Steel Type 304  
☐ Stainless Steel Type 316

**Customer:** \_\_\_\_\_

**Contact:** \_\_\_\_\_

**Phone:** \_\_\_\_\_

**Job Name:** \_\_\_\_\_

**Quantity:**

Please copy, complete form and fax back to 631.920.2343

**IMPORTANT:** Since every project is unique, the selection and use of an anchor system or any part there of must be determined by competent architects, engineers and/or other appropriate professionals who are familiar with the specific requirements of the project where these specific items are being used.

©2012 Corinthian Cast Stone, Inc. All rights reserved.

# STA-18: "U" BOLT

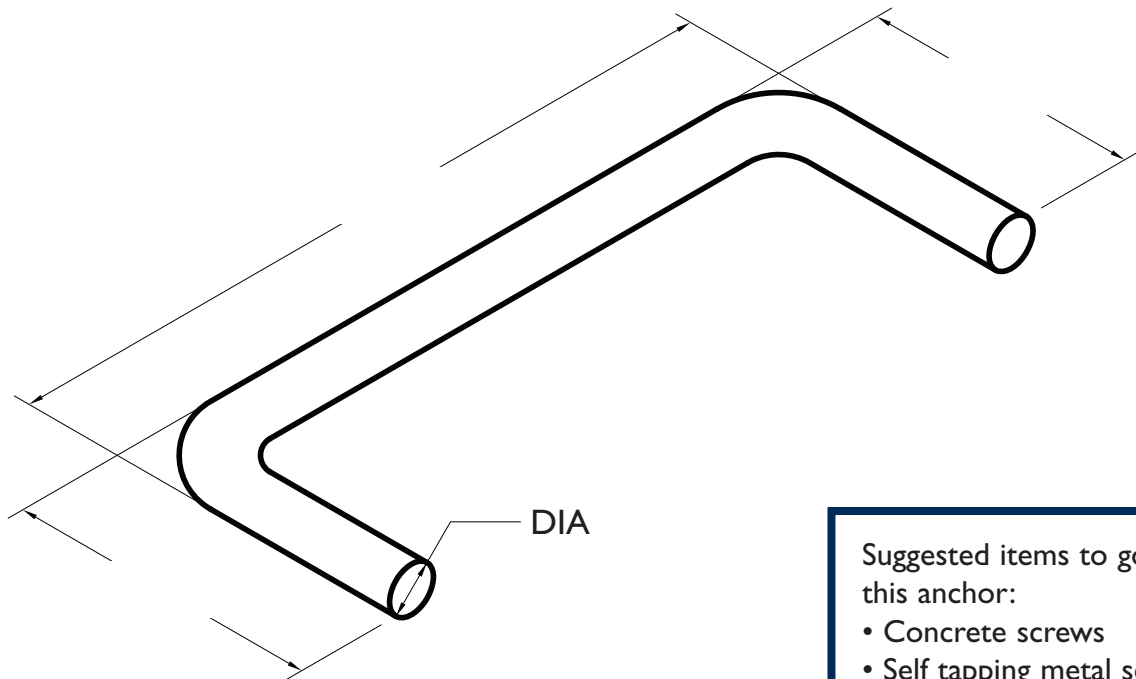

Suggested items to go with this anchor:

- Concrete screws
- Self tapping metal screws
- Expansion bolts
- Epoxy adhesive
- Plastic shims

**ST/ST Plate Min. Fy. = 45,000 p.s.i. (ASTM A666)**  
**ST/ST Rounds Min. Fy. = 75,000 p.s.i. (ASTM A580)**

**DRAWING FOR ILLUSTRATIVE PURPOSES ONLY**

## DIAMETER:

☐ 1/4"                      ☐ 1/2"  
☐ 5/16"                    ☐ 5/8"  
☐ 3/8"                      ☐ 3/4"  
                                ☐ Other: \_\_\_\_\_

## FINISH:

☐ Stainless Steel Type 304  
☐ Stainless Steel Type 316

**Customer:** \_\_\_\_\_

**Contact:** \_\_\_\_\_

**Phone:** \_\_\_\_\_

**Job Name:** \_\_\_\_\_

**Quantity:**

Please copy, complete form and fax back to 631.920.2343

**IMPORTANT:** Since every project is unique, the selection and use of an anchor system or any part there of must be determined by competent architects, engineers and/or other appropriate professionals who are familiar with the specific requirements of the project where these specific items are being used.

©2012 Corinthian Cast Stone, Inc. All rights reserved.